

BILL OF MATERIAL - KIT



Accessory: Floor Mat Set 4 Piece			Vehicle: Toyota Lexus			Model: _____ Year: 2009		
Part No: PT548-33090			Supplier: Pretty Products, LLC			Product wt: 3.43Kg.(7.56Lbs.)per set		
Part Color	Trim and Interior Color Code	Suffix	Part Color	Trim and Interior Color Code	Suffix	Part Color	Trim and Interior Color Code	Suffix
Brown		01						
Charcoal		12						

Item #	Level	Qty	Description	Supplier P/N	Toyota P/N
1	1	1	Mat, Front, Left - Brown	7S64L	n/a
	2	1	Warning Tag	325-14-0855	TFMT-0001
2	1	1	Mat, Front, Right - Brown	7S64R	n/a
3	1	1	Mat, Rear, Left - Brown	7S63L	n/a
4	1	1	Mat, Rear, Right - Brown	7S63R	n/a
5	1	1	Bag, Poly		n/a
	2	8	Clip Floor Retention Device	00206-00801	n/a
	2	1	Instructions, Installation		n/a

Format: (Subject, Adj, Location/ Adj)

Replacement Parts		
Toyota Replacement P/N	Description	Supplier P/N
00206-00801	Clip, Floor Retention Device	

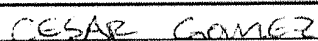
Revisions		
Date	Revision Description	ECR #
1/24/2006	Initial Release	07-199
7/31/2006	Retention Clips bagged	06-091
4/24/2008	Added Warning Tag	08-058
7/1/2008	Added Colors	08-104

TMS Approval	 CESAR GOMEZ TMS Engineer	 Signature	7/7/08 Date
--------------	---	---	----------------

REPLACEMENT PARTS

PT548-33090-CC(Suffix)

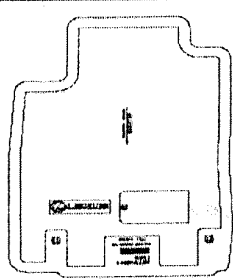

Front, Left

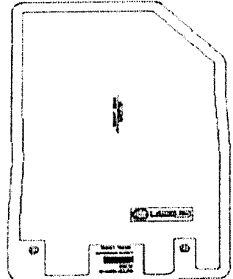

Front, Right

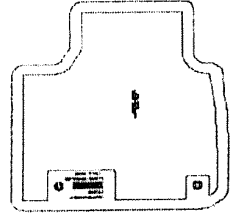

Rear, Left

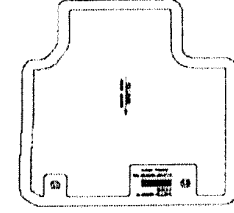

Rear, Right

"No Individual Service parts for this accessory"
 "Kit part number PT548-33090 to be used"

Clip, Floor Retention
00206-00801

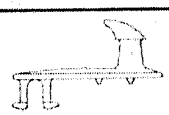

BILL OF MATERIAL - KIT

Accessory: Floor Mat Set 4 Piece			Vehicle: Toyota Lexus			Model: _____ Year: 2008		
Part No.: PT548-33070			Supplier: Pretty Products, LLC			Product wt.: 3.43Kg (7.56Lbs.) per set		
Part Color	Trim and Interior Color Code	Suffix	Part Color	Trim and Interior Color Code	Suffix	Part Color	Trim and Interior Color Code	Suffix
Black		02						
Cashmere		10						
Lt. Gray		11						

Item #	Level	Qty	Description	Supplier P/N	Toyota P/N
1	1	1	Mat, Front, Left - Black	7S64L	n/a
	2	1	Warning Tag	325-14-0855	TFMT-0001
2	1	1	Mat, Front, Right - Black	7S64R	n/a
3	1	1	Mat, Rear, Left - Black	7S63L	n/a
4	1	1	Mat, Rear, Right - Black	7S63R	n/a
5	1	1	Bag, Poly		n/a
	2	8	Clip Floor Retention Device	00206-00801	n/a
	2	1	Installation Instructions		n/a

Format: (Subject, Adj, Location/ Adj)

Replacement Parts		
Toyota Replacement P/N	Description	Supplier P/N
00206-00801	Clip, Floor Retention Device	

Revisions		
Date	Revision Description	ECR #
1/24/2006	Initial Release	07-199
7/31/2006	Retention Clips bagged	06-091
7/1/2008	Added Warning Tag	08-058

TMS Approval	CESAR GOMEZ	<i>Cesar Gomez</i>	7/17/08
	TMS Engineer	Signature	Date

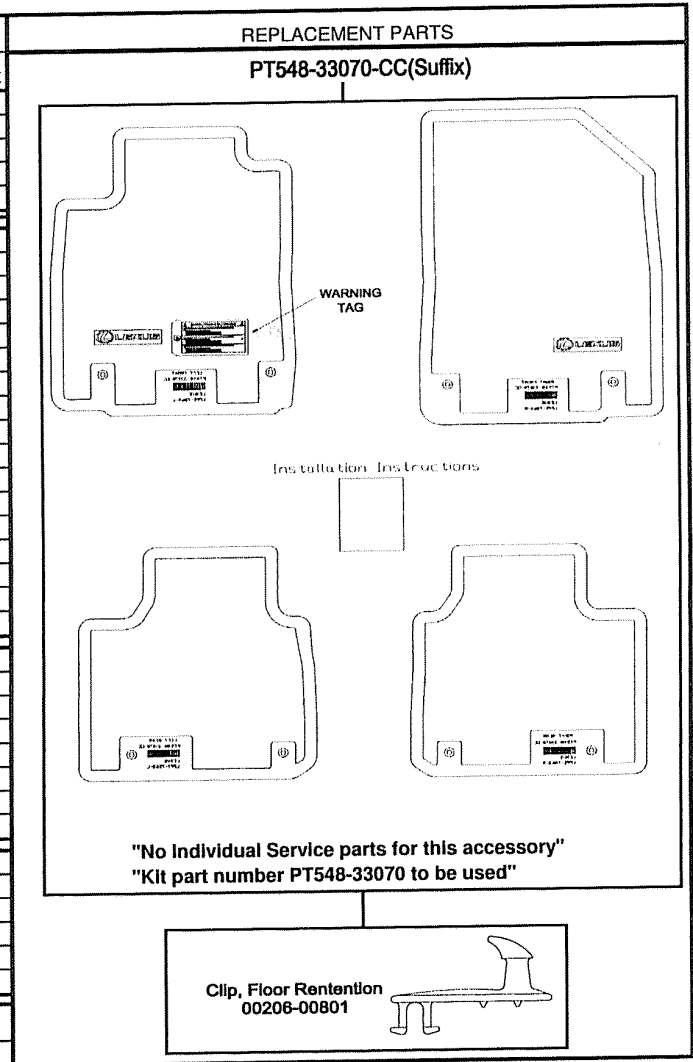

BILL OF MATERIALS - KIT

Accessory: Floor Mat Assy. 4 Piece, SE Pebble Beach Vehicle: Lexus 350 SE Model: ES350 Year: 2008, 2009

Part No.: PT548-33080-02/10/11 Supplier: Pretty Products, LLC. Product wt.: 3.43Kg.(7.56Lbs.)per set

Item #	Level	Qty:	Description	Supplier P/N	Toyota P/N
1	1	1	Floor Mat Set	7W97-S	PT548-33080-02/10/11
2	2	1	Floor Mat, Front, Left	7W96-S-1	n/a
3	2	1	Floor Mat, Front, Right	7W96-S-2	n/a
4	2	1	Floor Mat, Rear, Left	7S63-1	n/a
5	2	1	Floor Mat, Rear, Right	7S63-2	n/a
6	2	1	Bag, Poly	36060320	n/a
7	3	8	Retention Device	36040095	00206-00801
8	3	1	Installation Instructions		n/a

FOR REFERENCE USE ONLY

Replacement Parts		Supplier P/N
Toyota Replacement P/N	Description	
00206-00801	Clip, Floor Retention	

Revisions		
Date	Revision Description	ECR #
1/16/2008	Created new Pebble Beach SE version of ES350 floor mats with unique logo	07-199

TMS Approval: KEN TRAN Signature: [Signature] Date: 1/16/08
 TMS Engineer Signature Date

REPLACEMENT PARTS

**Clip, Floor Retention
00206-00801**

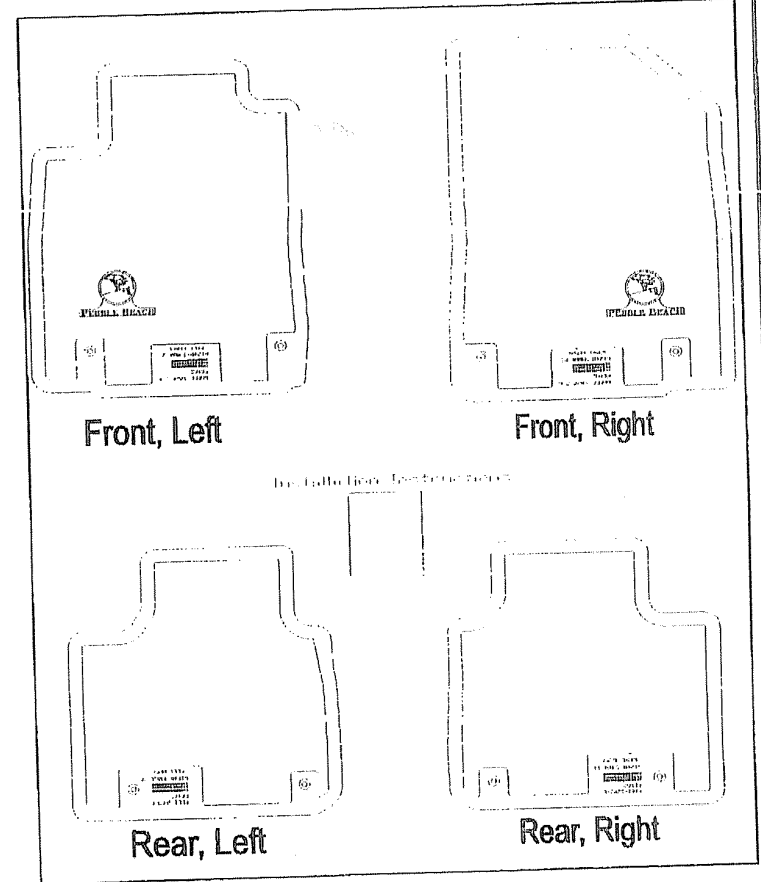
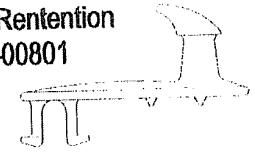

No service parts for this special edition; 2 sets of mats are included in each vehicle